

## Purpose of the Document

This document gives the instructions to properly mount any of the supported A395x-series mezzanine board on the DT5495 motherboard.









## Mezzanine Boards

The DT5495 Programmable Logic Unit supports a series of mezzanine board extensions listed below.

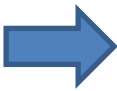
	<b>A395A</b>	32 LVDS/ECL/PECL input channels
	<b>A395B</b>	32 LVDS output channels
	<b>A395C</b>	32 ECL output channels
	<b>A395D</b>	8 NIM/TTL input/output channels
	<b>A395E</b>	8 Channel 16-bit $\pm 5V$ DAC

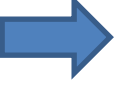
Refer to the DT5495 User Manual for complete technical specifications and additional information.

## Needed Tools

<p>2mm Allen key (or 2mm hex-head screwdriver)</p> 	<p>APPLIES TO</p> 	<p>3mm x 16mm Countersunk Allen head burnished screw</p>  <p><b>A</b></p>
<p>2.5mm Phillips screwdriver</p> 	<p>APPLIES TO</p> 	<p>2.5mm x 20mm Round head Phillips screw</p>  <p><b>B</b></p> <p>2.5mm x 4mm Round head Phillips screw</p>  <p><b>C</b></p> <p>3mm x 6mm Countersunk head Phillips screw</p>  <p><b>D</b></p>

## Cautions before You Start

**REMOVE POWER SUPPLY CONNECTION!!!**



**DETACH ANY CABLE FROM THE PANELS!!!**



## STEP 1: Remove the Rear Rubber Frame

- Unscrew the four countersunk Allen head burnished screws (A):



- Take off the rubber frame making slight pressures at both sides and along the profile:



## STEP 2: Remove the Upper Cover Panel

- Unscrew the central countersunk Phillips screw (D):



- Extract the upper cover keeping the rear panel just a bit down and flowing the cover out along the side guides:

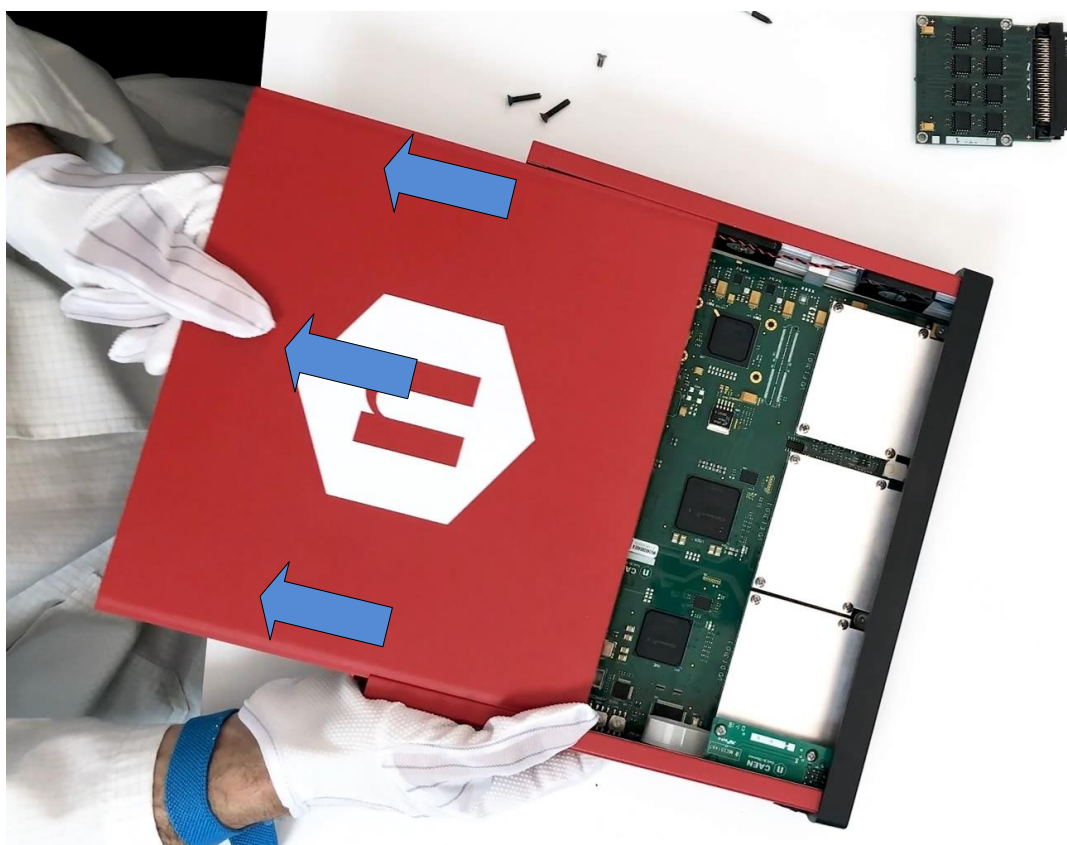

**NOTE:** during this operation, the side mechanics could misalign; just go on carefully with extracting the cover.



### STEP 3: Remove the Metal Plate

- Unscrew the four round head Phillips screws (C):

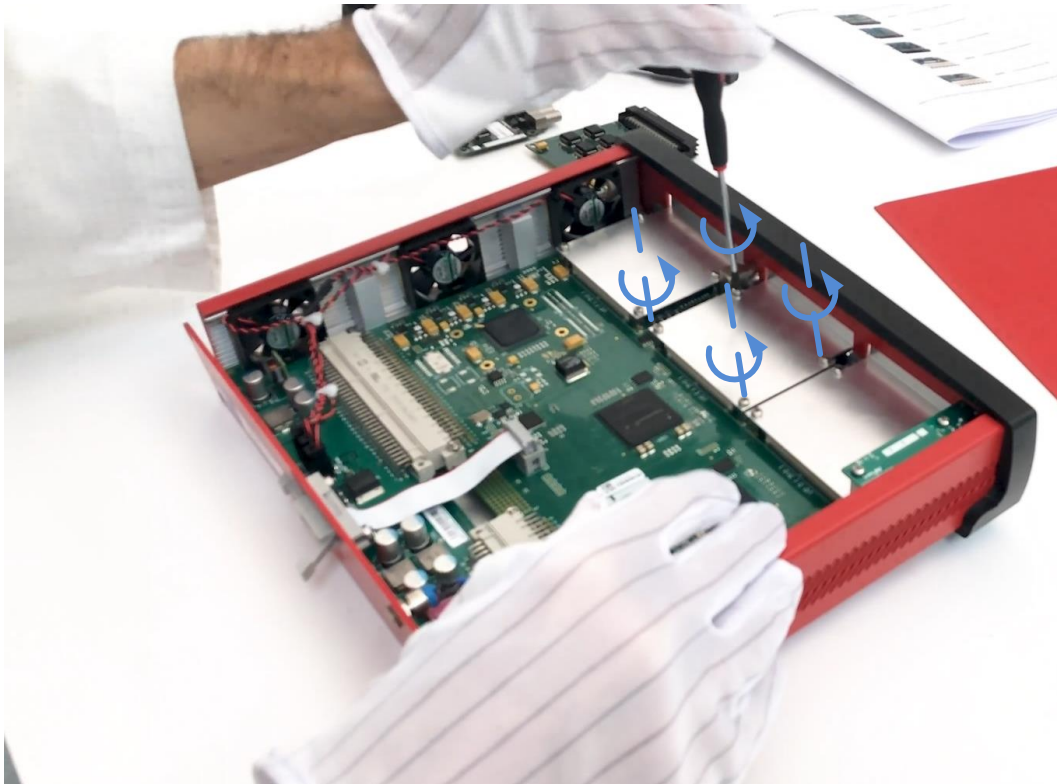

- Take off the metal plate:



## STEP 4: Mount the A395x Mezzanine

*There are no restrictions between the type of the A395x mezzanine and the slot to mount it.  
Select amongst the available slots according to your needs.*

- Plug the A395x mezzanine into the free socket:

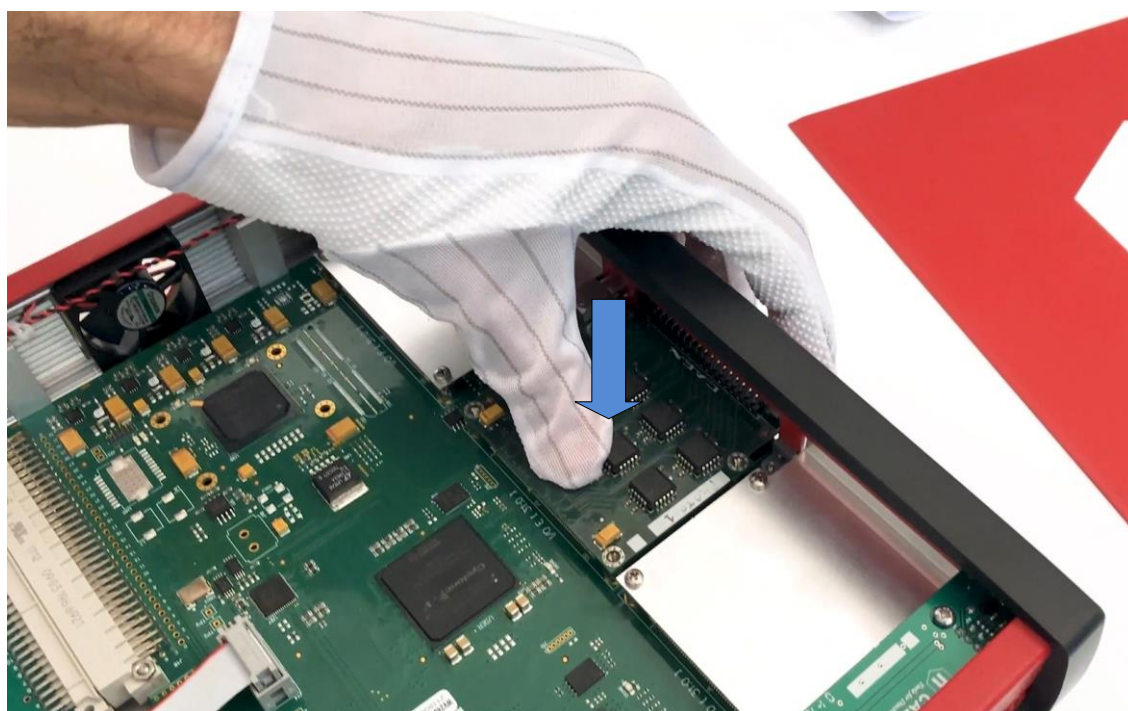
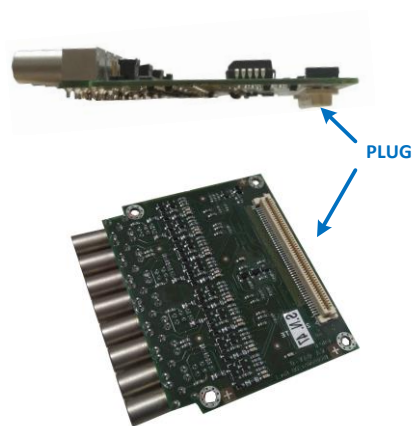



- Fix the A395x mezzanine by the four round head Phillips screws (C):

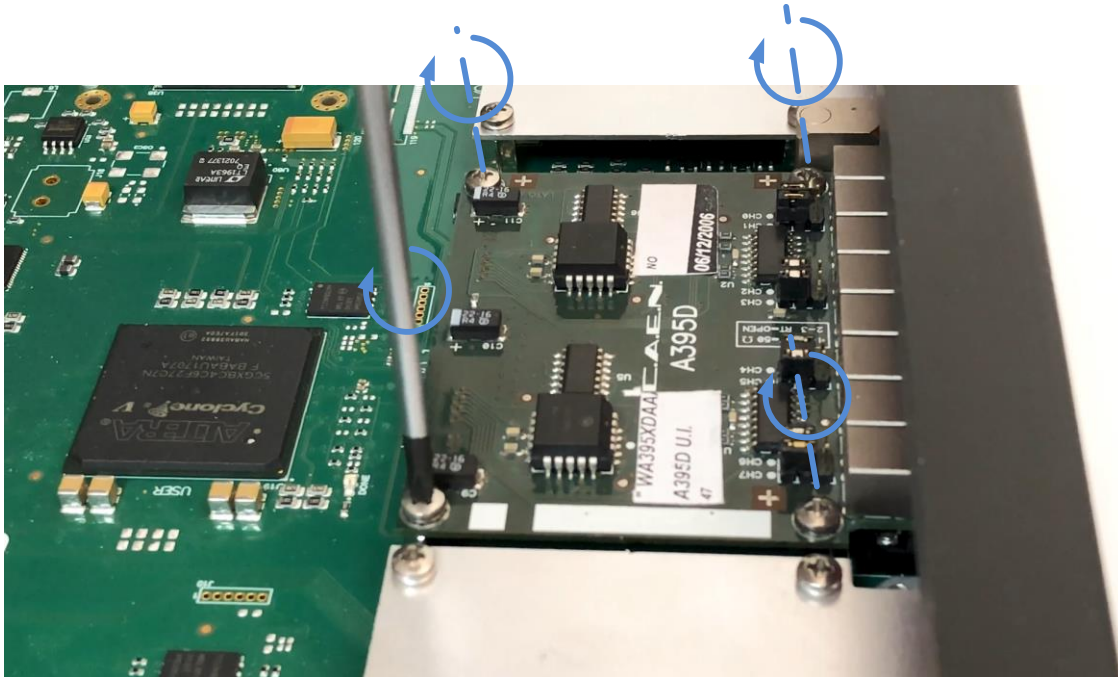

#### STEP 4a: Mounting on the Side ETH Slot

There is a side slot of the DT5495 which is mechanically matched with the Ethernet adapter piggyback. Installing an A395x mezzanine in this position requires some additional steps here described.

If you are not interested in this aspect, just move to [STEP 5](#) on.

- Remove the Ethernet adapter piggyback for first; unscrew the two long round head Phillips screws (B) and move out the two white spacers, then put the piggyback aside without detaching the bus cable:

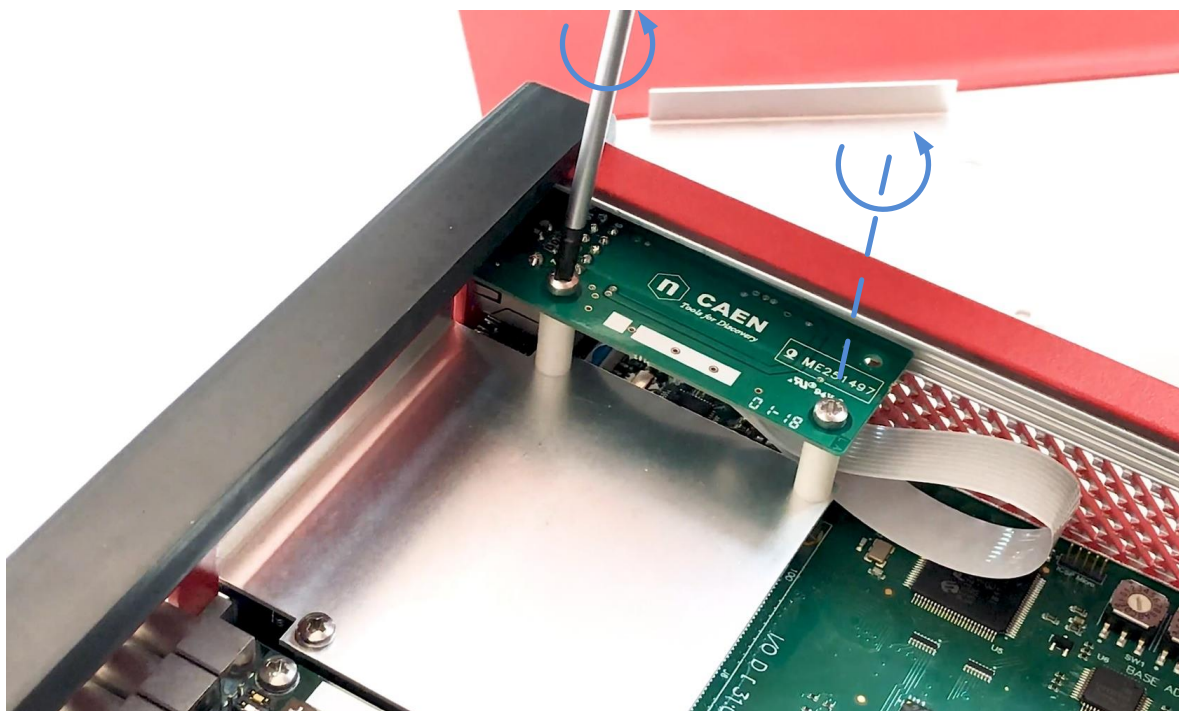

- Unscrew the two round head Phillips screws (C), then take off the metal plate:

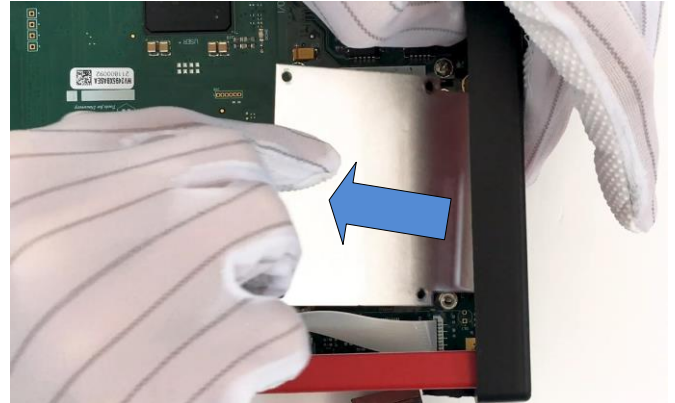
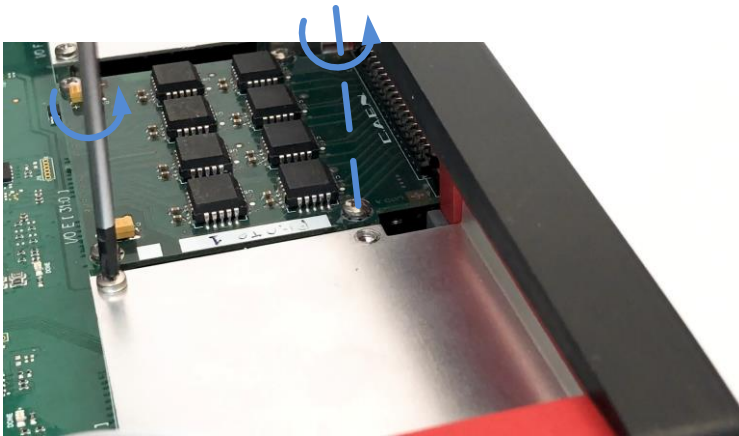

- Plug the A395x mezzanine into the motherboard slot:

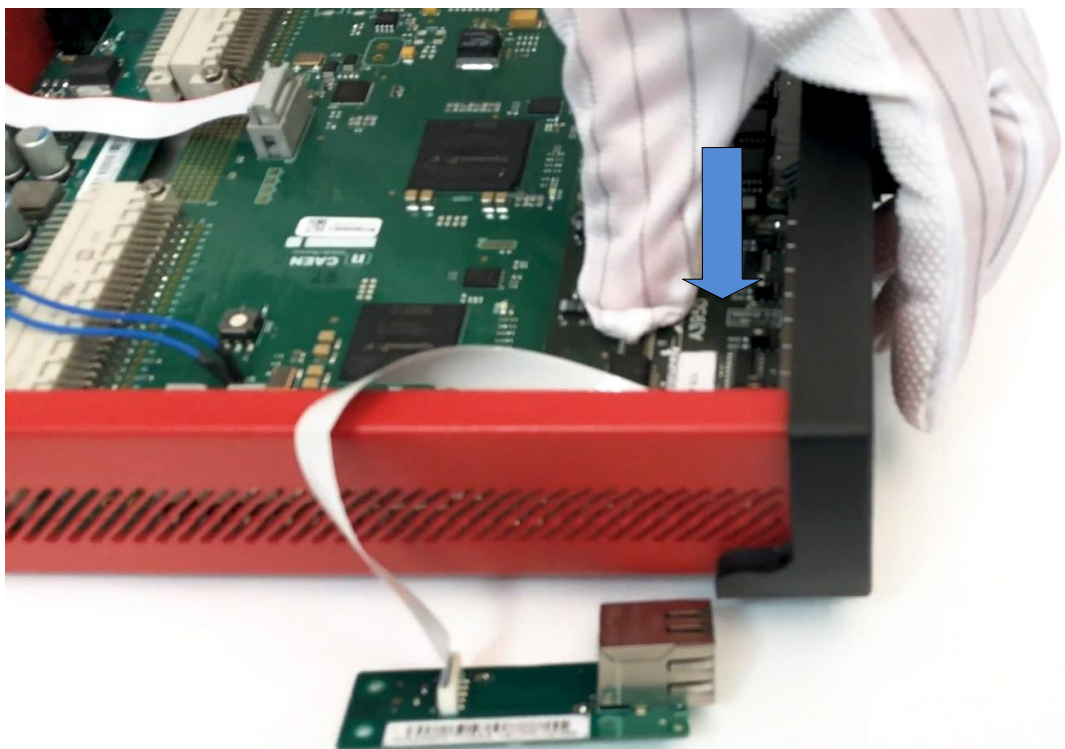



- Place properly the Ethernet adapter piggyback aside on the A395x mezzanine, insert the two plastic cylindrical spacers and then fix by the two **B** screws:

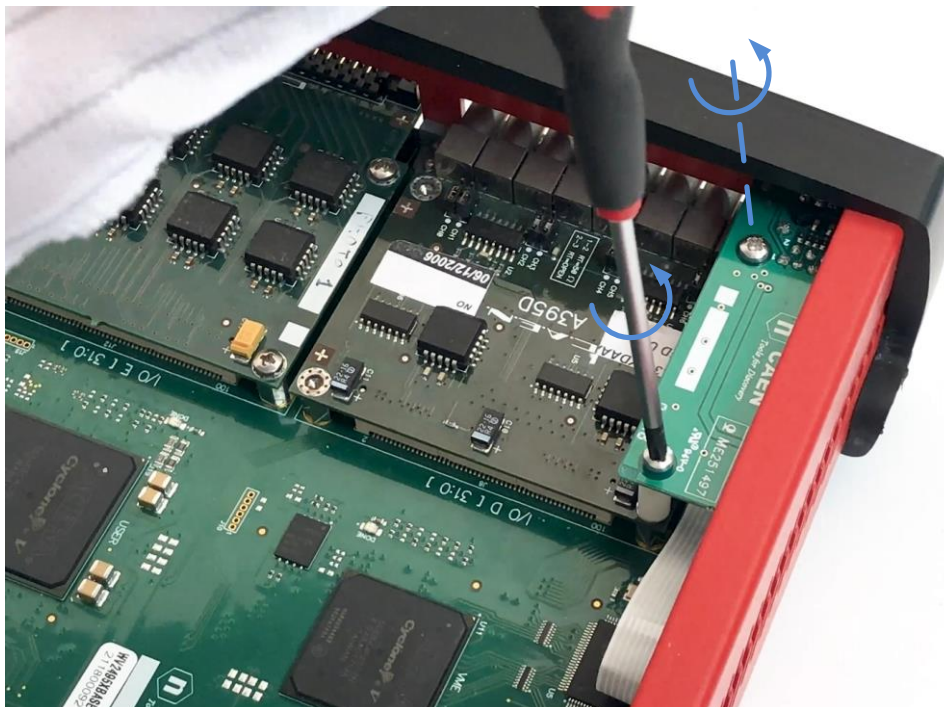

- Finally fix the A395x mezzanine by the two **C** screws:

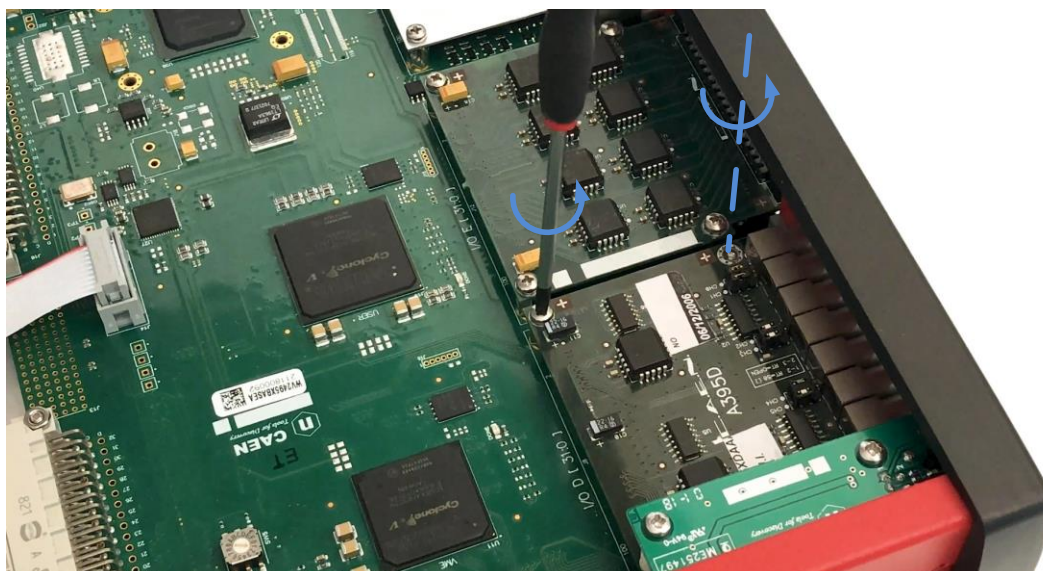

## STEP 5: Mount the Top Cover

- Make sure to align the lower cover panel and the side mechanics together with the PCB:

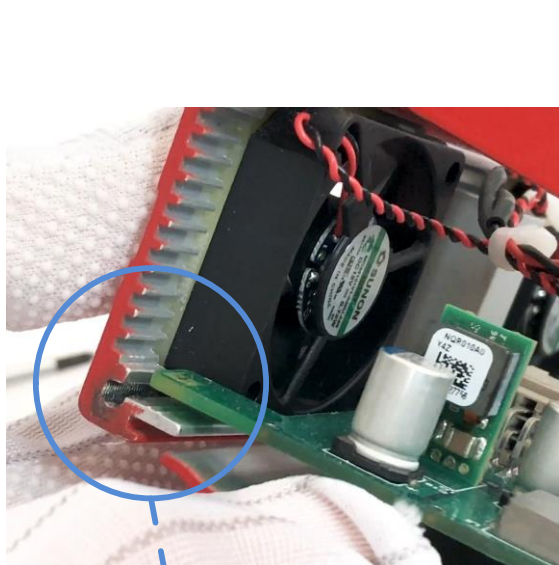

MISALIGNED

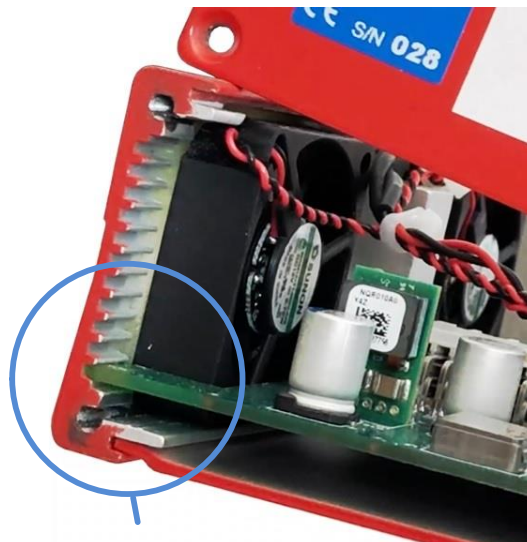

ALIGNED

- Insert the top cover making it flow along the side guides till it secures to the front panel.

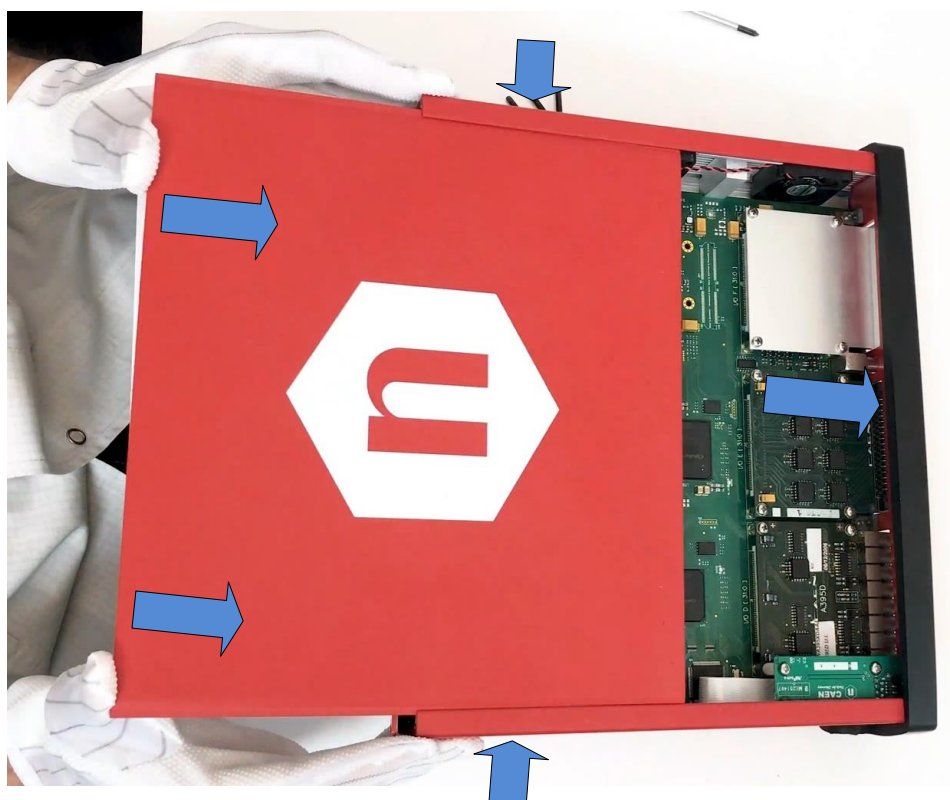

**NOTE:** CAEN Logo must be conventionally readable from the front

- Place the rear panel and fix it by the central countersunk Phillips screw (D):

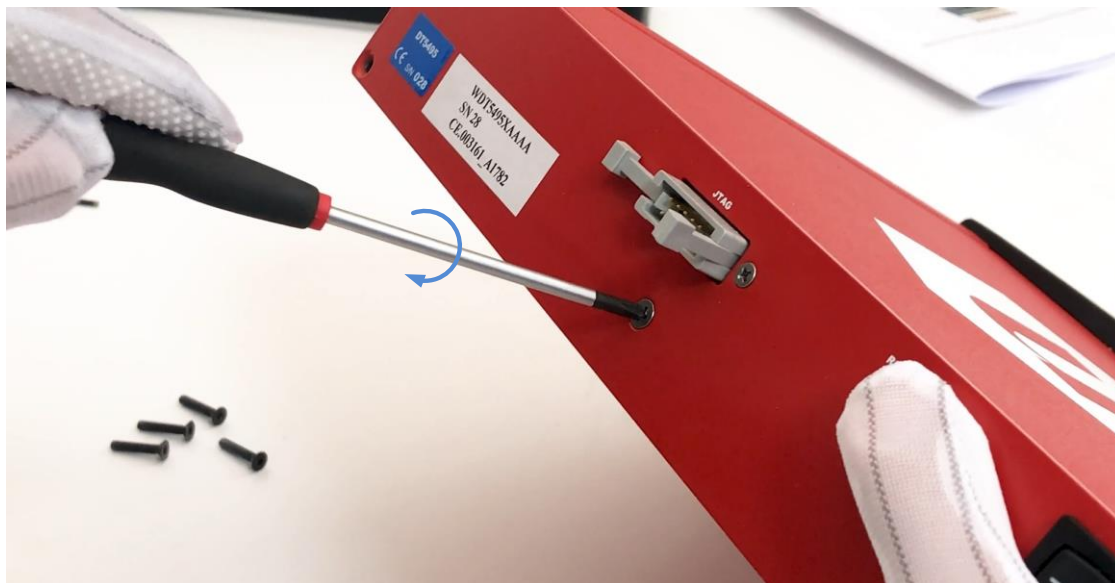

## **STEP 6: Mount the Rear Rubber Frame**

- Fit the rubber frame to the rear panel pressuring along the profile:





- Secure the rubber frame by the four countersunk Allen head burnished screws (A):



 Do not force screwing at the end of the stroke, as this may damage the rubber screw seat.

## Conclusion

Your DT5495 equipped with the A395x mezzanine(s) is now ready to work:



## Contacts

In case of any further support you may need, do not hesitate to contact CAEN specialists by filling in the form at the following link:

<https://www.caen.it/support-services/support-form/>



rev.0 – February 6th, 2019

Copyright © CAEN SpA. All rights reserved. Information in this publication supersedes all earlier versions. Specifications subject to change without notice.